

- ▣ Multi-jet wet type
- ▣ 360°C rotatable cover
- ▣ Display on 5 drums m<sup>3</sup> and 4 pointers for litres
- ▣ Optional check valve
- ▣ Measuring range up to R160
- ▣ Brass housing
- ▣ Water temperature up to 50°C



## Technical Specification

|                                     |                                |                   | 15           | 20           |
|-------------------------------------|--------------------------------|-------------------|--------------|--------------|
| Nominal diameter                    | DN                             | mm                |              |              |
| Nominal flow rate                   | Q <sub>s</sub>                 | m <sup>3</sup> /h | 2,5          | 2,5          |
| Maximum flow rate                   | Q <sub>4</sub>                 | m <sup>3</sup> /h | 3,125        | 3,125        |
| Minimum flow rate                   | Q <sub>1</sub>                 | l/h               | 31,2/25/15,6 | 31,2/25/15,6 |
| Transitional flow rate              | Q <sub>2</sub>                 | l/h               | 50/40/25     | 50/40/25     |
| Maximum working pressure            | P <sub>max</sub>               | bar               | 16           | 16           |
| Pressure loss (max.Q <sub>3</sub> ) | ΔP                             | bar               | 0,40         | 0,40         |
| Maximum working temperature         | T <sub>max</sub>               | °C                | 50           | 50           |
| Measuring range                     | Q <sub>3</sub> /Q <sub>t</sub> | R                 | 80/100/160   | 80/100/160   |
| Overall length                      | L                              | mm                | 165          | 190          |
| Maximum register indication         |                                | m <sup>3</sup>    | 99.999       | 99.999       |
| Verification scale interval         |                                | l                 | 0,05         | 0,05         |
| Width                               | B                              | mm                | 95           | 95           |
| Total height                        | H                              | mm                | 105          | 105          |
| Height to pipe axis                 | h                              | mm                | 34           | 34           |
| Connection thread of meter          | -                              | -                 | G3/4B        | G1B          |
| Nominal size                        | DN                             | mm                | 15           | 20           |
| Pipping dimensions                  | -                              | -                 | G1/2B        | G3/4B        |
| Weight                              | -                              | kg                | 1,300        | 1,350        |
| Installation position               |                                |                   | H            | H            |



## Dimensions

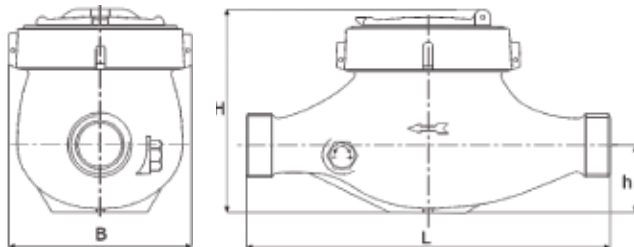

## Error Curve

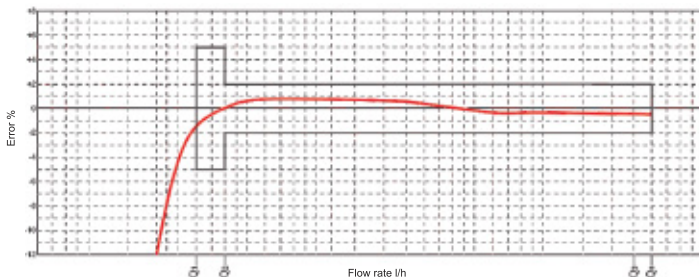

## Pressure Loss

